

Certificate

Certified Passive House component

For cool temperate climates, valid until 31 December 2017

Category: **Entry door**
Manufacturer: **Hebei Orient Sundar Window Co.,Ltd.**
Gaobeidian City, Hebei Province, CHINA
Product: **Passive 78 super dpIII**

This certificate was awarded based on the following criteria:

Heat losses through the installed entry door:

U-value of the installed door (1.10 m width by 2.20 m length):

$$U_{D,installed} = 0.78 \text{ W/(m}^2\text{K)} \leq 0.80 \text{ W/(m}^2\text{K)}$$

Provided that the installation is carried out according to the certification report, available from the manufacturer.

Component U-Value: $U_D = 0.72 \text{ W/(m}^2\text{K)}$.

The component is equipped with a door leaf with an $U_{pnl} = 0.51 \text{ W/(m}^2\text{K)}$, which is considered for the determination of the U_D -value.

Airtightness:

Airtightness class 3 according to EN 12207.

The airtightness criterion has been fulfilled.

The airtightness test has been carried out according to the regulations of the testing method GB/T 7106/-2008 (Graduations and test methods of air permeability, watertightness, wind load resistance performance for building external windows and doors).

Passive House Institute
Dr. Wolfgang Feist
64283 Darmstadt
Germany

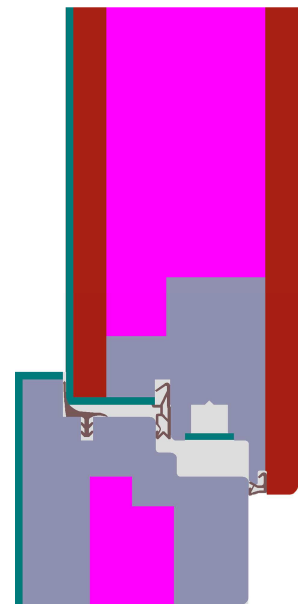
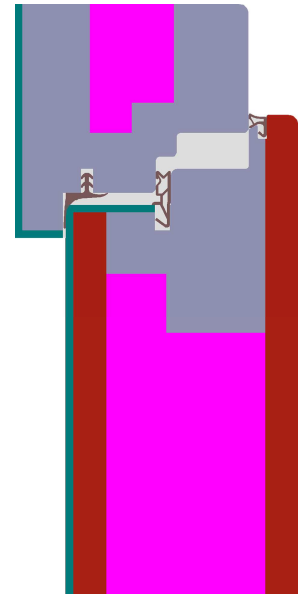

vertical section

U-value entry door
including the above mentioned
door leaf with $U_{pnl} = 0.51 \text{ W/(m}^2\text{K)}$

$$U_D = 0.72 \text{ W/(m}^2\text{K)}$$

For further information, please see data sheet.

www.passivehouse.com

0927ed03



**CERTIFIED
COMPONENT**

Passive House Institute